

ENACC-PRG-INT

Optional iCANnet Programming Port for EN Series Controllers

Key Features

- Can be installed in any EN Series Pre-populated hardwired controller as well as EN1-14 and EN3-42 empty enclosures
- Provides connection to the internal panel network for programming and maintenance
- Supplied with RJ12 interconnecting lead
- CE & UKCA compliant to all relevant standards
- Designed and manufactured to ISO9001 standard

Environmental Data

Temperature Range: 0°C to +40°C

Humidity: 5 - 95% non condensing

Rating: IP20

Dimensions (mm)

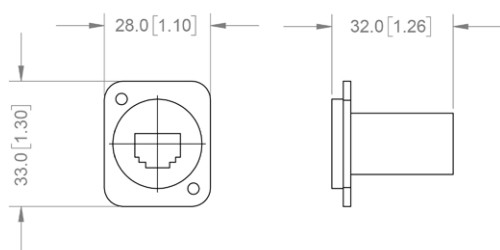

Overview

The optional RJ12 programming port can be installed to the underside of any EN Series controller*. It is then connected to the ENACC-LND-INT landing card via an RJ12 lead to provide external connection to the network for programming and maintenance.

*Not compatible with EN1-3 Enclosures.

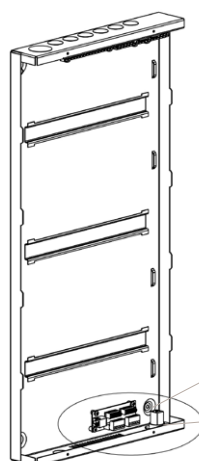

Example location of ENACC-PRG-INT in an EN Series Enclosure

Contact Us

+44 (0)1923 495495

enquiries@iLight.co.uk

www.iLight.co.uk

iLight

A brand of Signify
Usk House, Llantarnam Park
Cwmbran, NP44 3HD, UK

© 2022 Signify Holding
All Rights Reserved

ENACC-PRG-INT Rev1 0322

Changes to the products, to the information contained in this document, and to prices are reserved; so are errors and omissions.

iLight is a registered trademark.
All other trademarks are property of their respective owners.

