

## Cooper Lighting Solutions

Usk House, Lakeside  
Llantarnam Park,  
Cwmbran,  
NP44 3HD, UK

t: +44 (0)1923 495495  
e: info@cooperlighting.co.uk  
www.cooperlighting.co.uk

## SCMR1232

12 x 32A Relay Controller



E&OE. iLight reserve the right to make changes to the equipment without prior notice.  
© Cooper Lighting Solutions  
Doc No: 9850-000537-03



## Typical Schematic

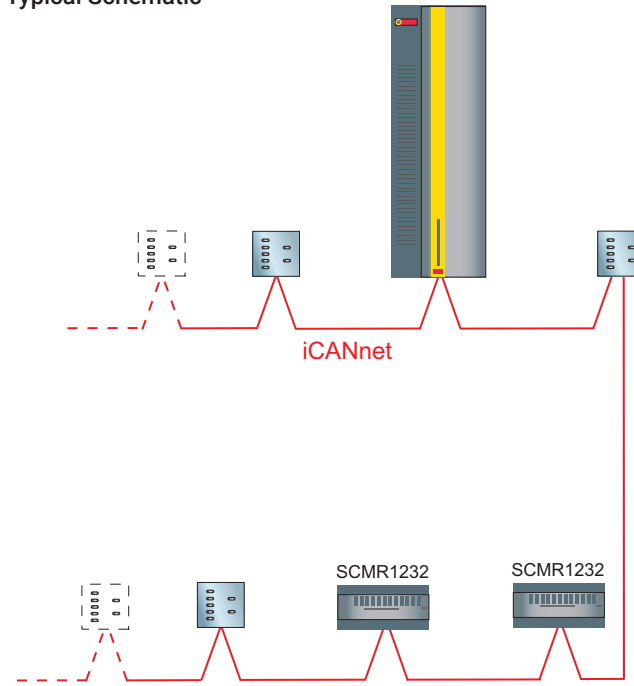

## Mounting & Installation

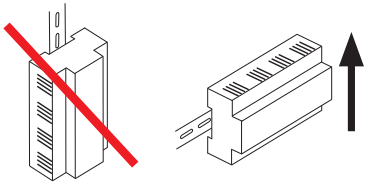

**SCMR1232 must be mounted in a suitable enclosure to provide regulatory protection from electric shock hazard as well as protecting the iCANnet data network from tampering that could lead to reduced network security.**

**Ensure selected enclosure provides adequate cooling ventilation.**

### Fixing to DIN rail

1. Fix top clips over DIN rail.
2. Pull down bottom clip using screwdriver.
3. Close module towards DIN rail.
4. Push up bottom clip to fix securely to DIN rail.

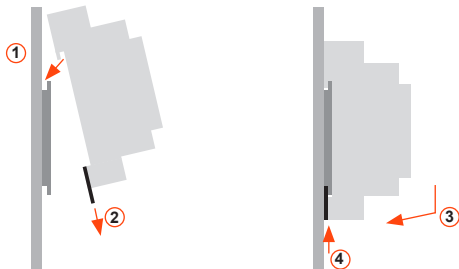

### Removing from DIN rail

1. Pull down bottom clip with screwdriver.
2. Lift module away from DIN rail.

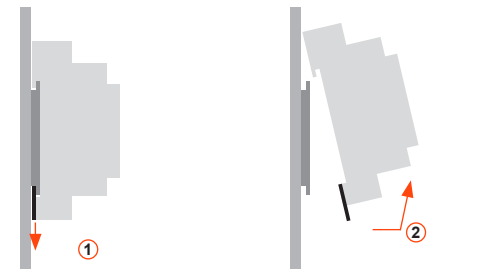

## Technical Data

### Electrical & Mechanical

Control: Via iLight network connection

Rating: 32A\* per channel @ 40°C

Protection: Provided by installer

Output channel current: Maximum 12 x 32A\*  
(Total unit load not to exceed 192A)

Note: Fully loaded channels should be spaced every other channel to prevent heat buildup

Relay outputs: Volt free capable of switching inductive and resistive loads

Terminal Sizes: Loads - maximum cable size: 1 x 10mm<sup>2</sup> per circuit

Ambient temperature: 2°C – 40°C

Relative humidity: 5% - 95% max, non-condensing

IP rating: IP20

Installation: Installation must be carried out by a suitably qualified electrician and installed in a suitable DINrail enclosure.

Dimensions: 212mm (w) x 90mm (h) x 58mm (d)

Weight: 0.8kg

### Software

For programming SCMR1232, Device Editor V2.11.1 is required  
(Packaged with iCANsoft V3.1.7 or later)

\* 32A resistive per channel @ 400C - 20A capacitive per channel @ 400C

# SCMR1232

12 x 32A Relay Controller

Typical Connection Diagram

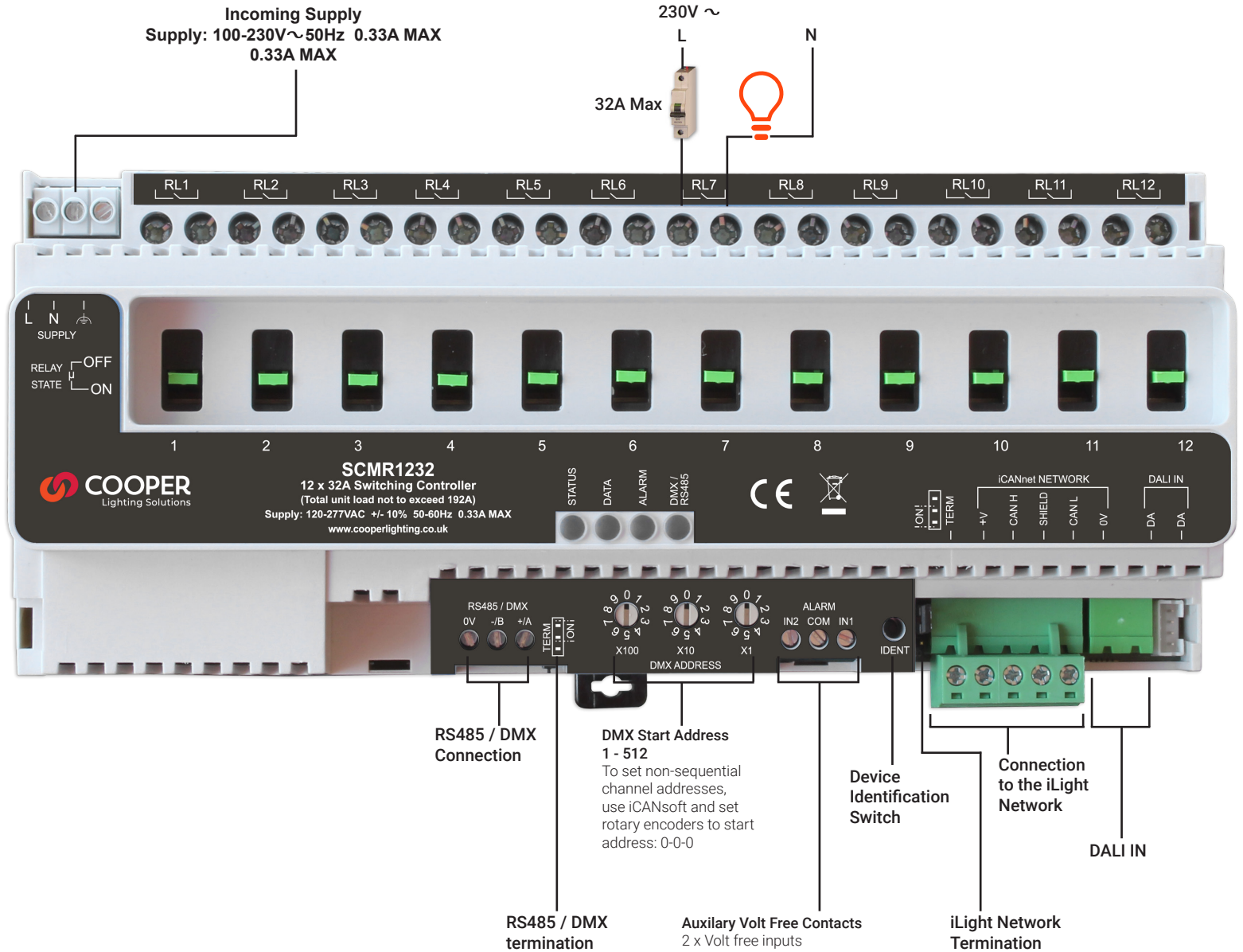

## Device LEDs and Buttons

### Status LED

Green LED flashes – device OK

### Data LED

Red LED flashes when messages sent on network.

### Alarm LED

Red LED solid on for local initiated alarm  
Red LED flashes for network initiated alarm

### RS485 / DMX LED

Green LED flashes when DMX or RS485 messages are sent or received

### Device Identification

Press and release switch.  
Sending a message to identify the device on the network (red Data LED flashes).